

# ARLINGTON

Starting from \$497,900  
Est. Mortgage

(623) 399-4783





## OVERVIEW

 Litchfield Park, AZ

 5 - 6 Bedrooms

 2,926 Sq. Ft.

 From \$380s - \$590s

 3 Bathrooms

The Arlington is a two-story home that offers you a choice between a traditional enclosed study for a quiet workspace, or a formal dining room, perfect for hosting dinner parties. Upstairs, enjoy trivia nights and snacks with family and friends in your cozy loft.

## FLOORPLAN

### 1st Floor

Base Floorplan



FIRST FLOOR

Room Choices Floorplan

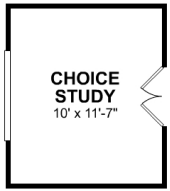

**CHOICE STUDY**

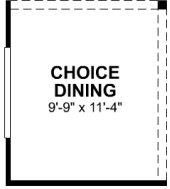

**CHOICE DINING**

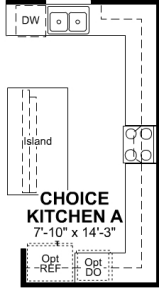

**CHOICE KITCHEN A**

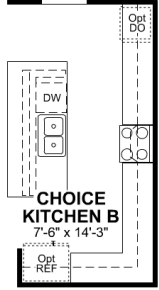

**CHOICE KITCHEN B**

**Paid Options Floorplan**

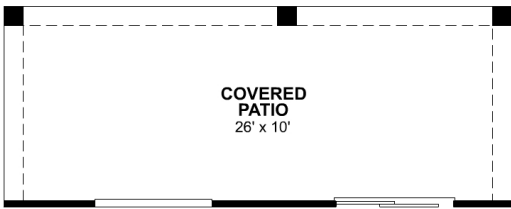

**OPTIONAL EXTENDED COVERED PATIO**

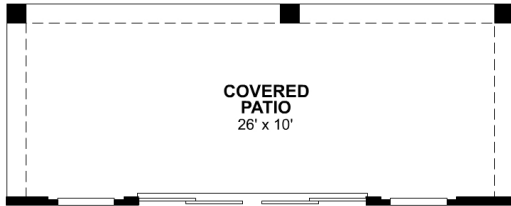

**OPTIONAL 12' SLIDING GLASS DOOR  
W/ EXTENDED COVERED PATIO**

**2nd Floor**

**Base Floorplan**

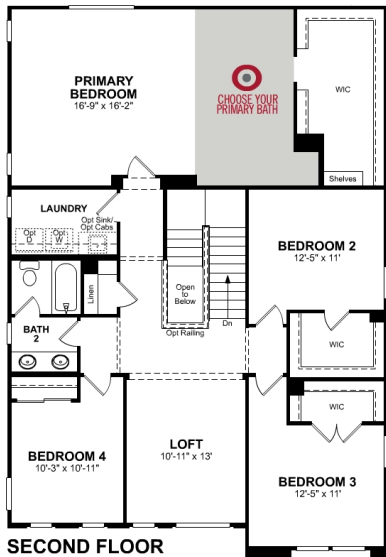

**Room Choices Floorplan**

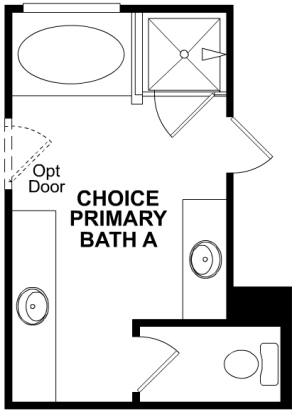

**CHOICE PRIMARY BATHROOM A**

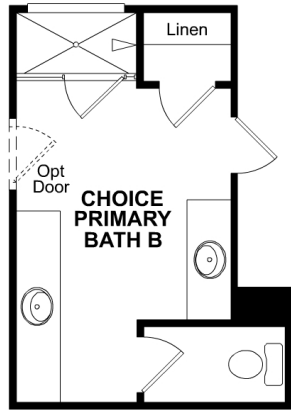

**CHOICE PRIMARY BATHROOM B**

Paid Options Floorplan

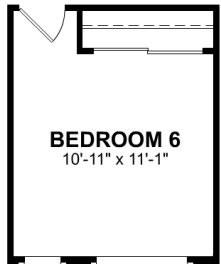

**OPTIONAL BEDROOM 6 ILO LOFT**

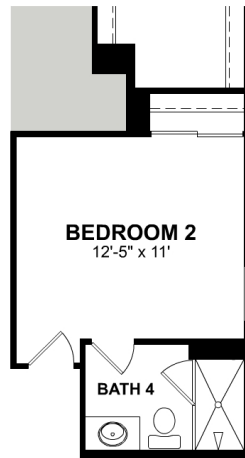

**OPTIONAL PRIVATE BATH 4 ILO WIC @ BEDROOM 2**

**DETAILS AND FEATURES**

- The foyer provides a welcoming environment for guests that leads to a large great room
- The kitchen features spacious countertops and a walk-in pantry to maximize storage
- A spacious loft is designed to be a versatile space for play or entertainment
- Laundry room located near the primary bedroom for your convenience