

# CHATSWORTH

Starting from \$381,900  
Est. Mortgage

(623) 399-4783





## OVERVIEW

 Litchfield Park, AZ

 3 Bedrooms

 1,501 Sq. Ft.

 From \$380s - \$590s

 2 Bathrooms

The Chatsworth is a single-story home featuring a study and a cozy, secluded primary bedroom situated at the back of the home for optimal privacy. The open-concept kitchen and great room offer easy access to the rear covered patio, perfect for outdoor dining and activities.

## FLOORPLAN

### 1st Floor

Base Floorplan

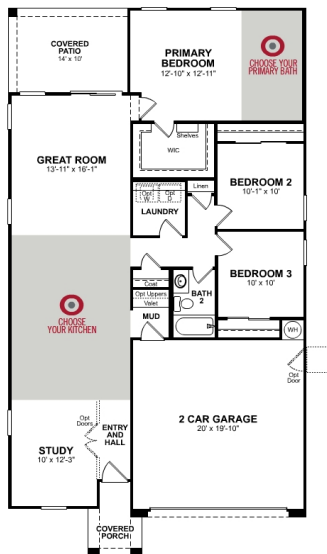

Room Choices Floorplan

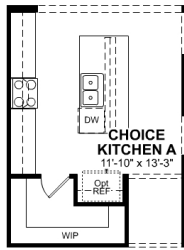

**CHOICE KITCHEN A**



**CHOICE PRIMARY BATH A**

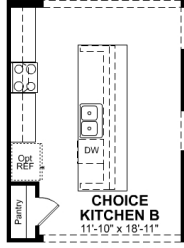

**CHOICE KITCHEN B**

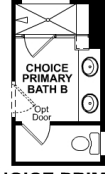

**CHOICE PRIMARY BATH B**

Paid Options Floorplan

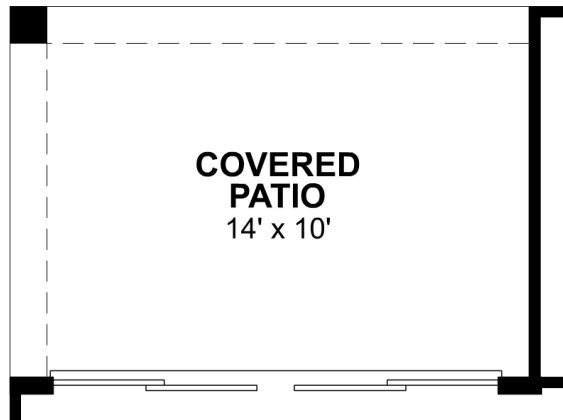

## OPTIONAL 12' SLIDING GLASS DOOR

### DETAILS AND FEATURES

- The foyer provides a large space to welcome guests into your home
- The kitchen is conveniently located near the garage, making it easier than ever to unload groceries
- The study is positioned at the front of the home to maximize your privacy while working from home
- Create lasting memories in your new great room - perfect for game nights, movie nights, and entertaining