

# THE YORKTOWN

Approx. 2,910 sq. ft. | 2 stories | 4-5 bedrooms | 2- to 3-car garage | Plan #P725



ELEVATION C - SHOWN W/OPT. STONE

## ABOUT THE YORKTOWN

The main floor of the Yorktown was designed for entertaining, offering an expansive great room with optional fireplace, an open dining room overlooking a covered patio and backyard and a well-appointed kitchen with a large center island. The 3-car garage leads to a convenient mudroom with walk-in closet, a powder room and a private study. On the second floor, there's an immense loft surrounded by three bedrooms, a shared bath, a laundry room and a master suite with its own bath and spacious walk-in closet. Options include a sunroom, extra bedrooms and a deluxe bath.



ELEVATION A



ELEVATION B - SHOWN W/OPT. STONE

MAIN FLOOR

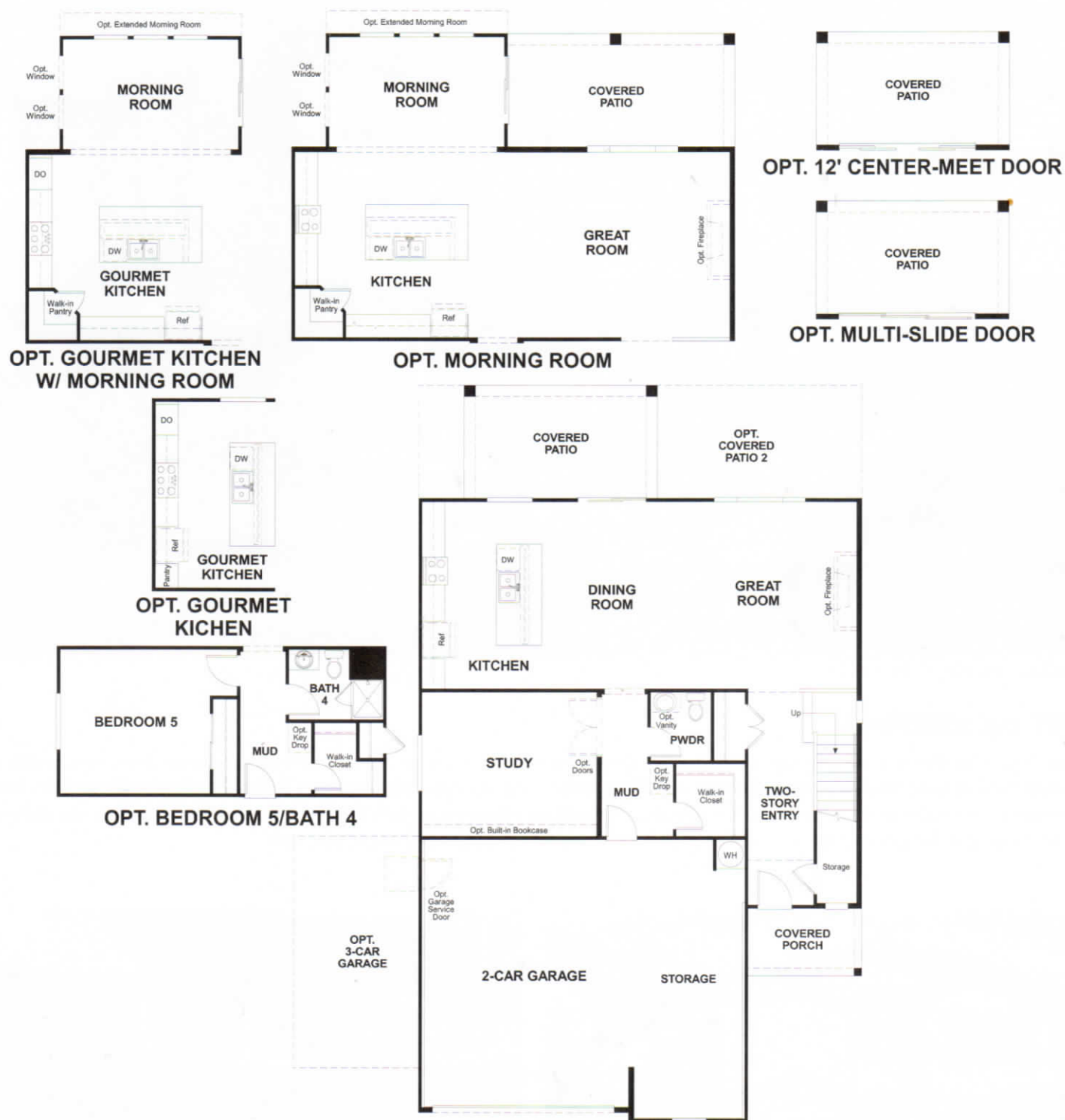

THIS PLAN'S PROJECTED  
**HERS® INDEX = 62\***  
Projected Rating Based on Plans – Field Confirmation required

How does this floor plan rate?

Take a look: **100** = Standard new home\* **130** = Typical resale Home\*\*  
The lower number, the better! Refer to the RESNET® HERS index brochure or go to [www.RESNET.us](http://www.RESNET.us) and [www.HERSindex.com](http://www.HERSindex.com)



## SECOND FLOOR

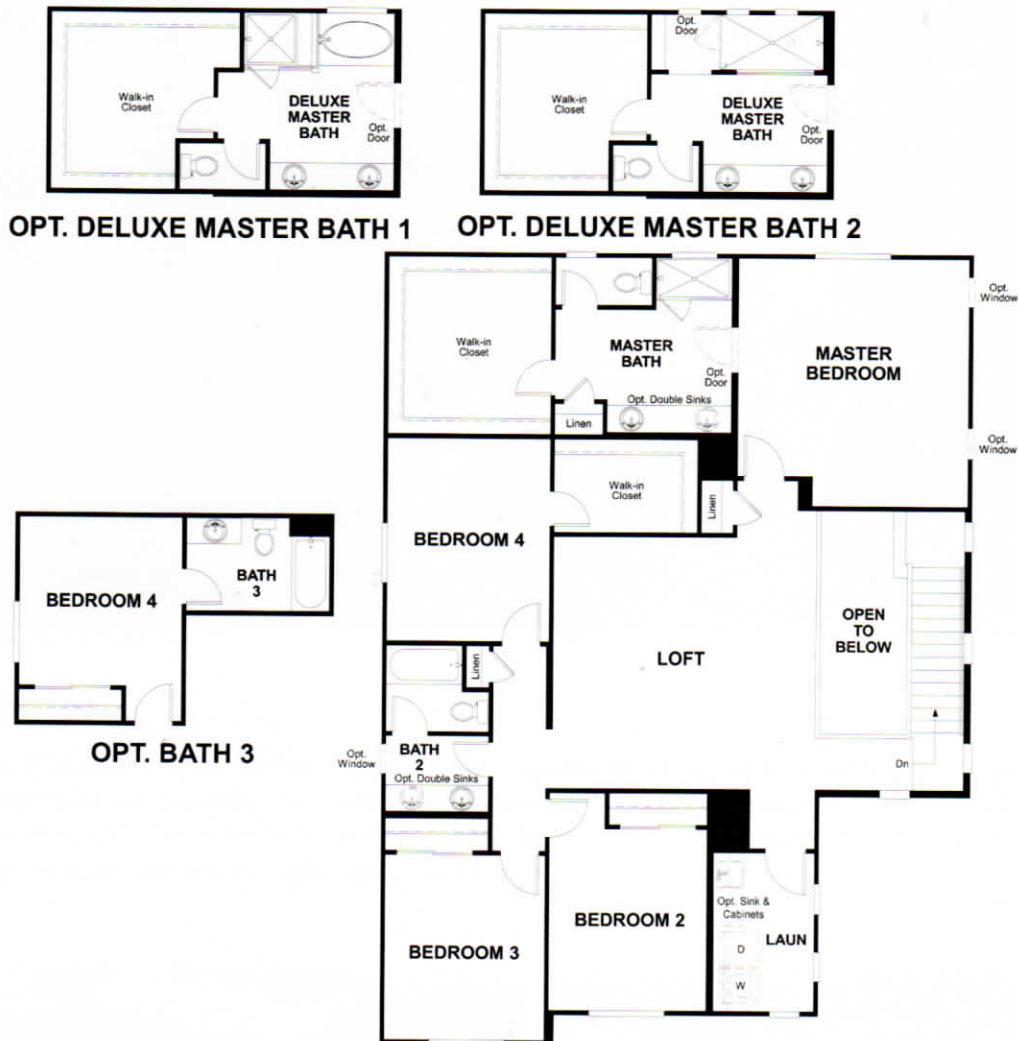

**What's a HERS® Index?** HERS stands for Home Energy Rating System, a system created by RESNET® to measure home energy efficiency.®

A Projected HERS index or rating is a computer simulation performed prior to construction by a third-party HERS rater using RESNET accredited rating software, rated feature and specification data derived from home plans, features and specifications, and other data selected or assumed by the rater. The projected HERS index is approximate and is subject to change without notice. Actual results will vary.