

# REMERTON

Coming Soon  
Est. Mortgage undefined

(623) 399-4787



## OVERVIEW

 Litchfield Park, AZ

 5 Bedrooms

 3,186–3,201 Sq. Ft.

 From \$360s - \$540s

 4.5 Bathrooms

The two-story Remerton plan features an expansive entry and hall to welcome guests into your home, and a gallery wall to display artwork or collections. Personalize your floorplan with your choice of a formal dining room, or an enclosed study. Upstairs, relax with a movie night in your cozy loft.

## FLOORPLAN

### 1st Floor

Base Floorplan



Room Choices Floorplan

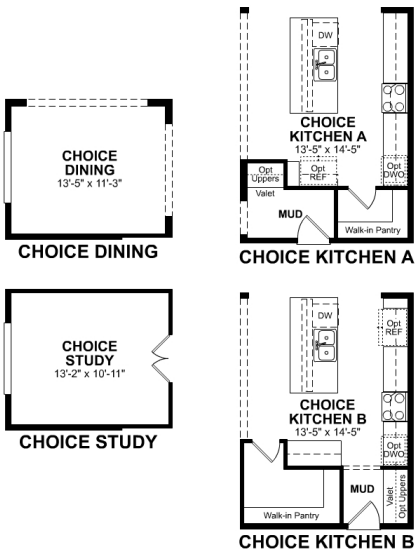

Paid Options Floorplan

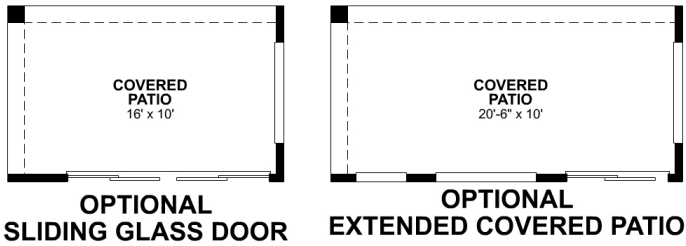

**2nd Floor**

Base Floorplan



**SECOND FLOOR**

Room Choices Floorplan

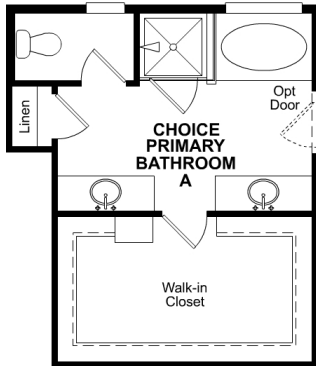

**CHOICE PRIMARY BATHROOM A**

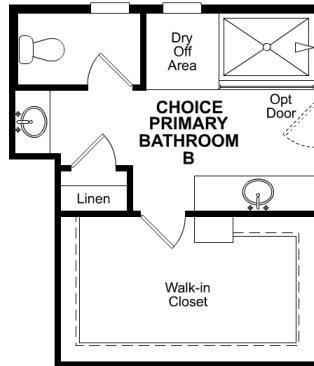

**CHOICE PRIMARY BATHROOM B**

## DETAILS AND FEATURES

- Open-concept kitchen features spacious countertops and walk-in pantry to maximize storage
- Laundry located near the primary bedroom for your convenience
- Kitchen located close to the garage, making it easier to unload groceries and home supplies from your car
- Separate primary bathroom vanities create more space and privacy