

# HARTWELL

Coming Soon  
Est. Mortgage undefined

(623) 399-4787



## OVERVIEW

 Litchfield Park, AZ

 4 Bedrooms

 2,757–2,761 Sq. Ft.

 From \$360s - \$540s

 2.5 - 3.5 Bathrooms

The Hartwell is a two-story home featuring a cozy breakfast area off the covered patio for enjoying a meal while taking in the backyard views. Choose from a formal dining room, ideal for holiday gatherings, or an enclosed study for a quiet home office or playroom.

## FLOORPLAN

### 1st Floor

Base Floorplan



**Room Choices Floorplan**

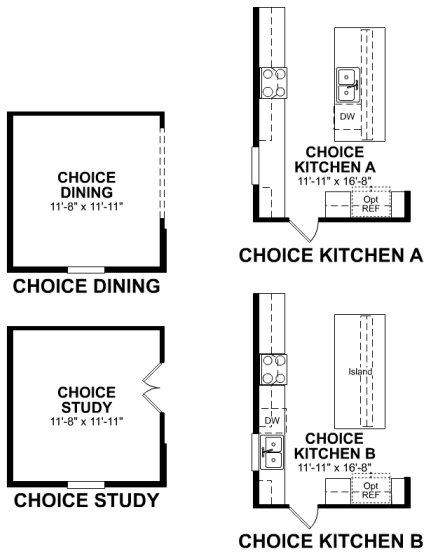

**Paid Options Floorplan**

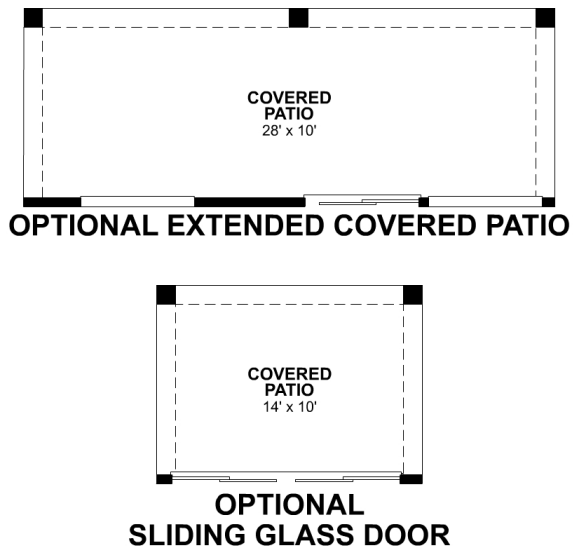

**2nd Floor**

**Base Floorplan**



**SECOND FLOOR**

Room Choices Floorplan

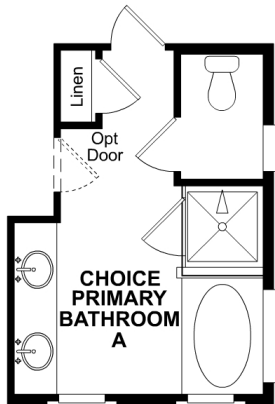

**CHOICE PRIMARY BATHROOM A**

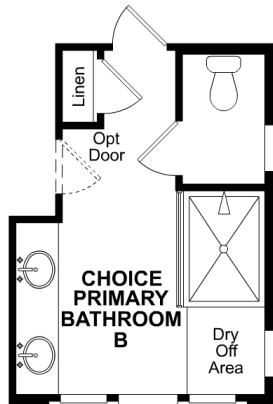

**CHOICE PRIMARY BATHROOM B**

Paid Options Floorplan

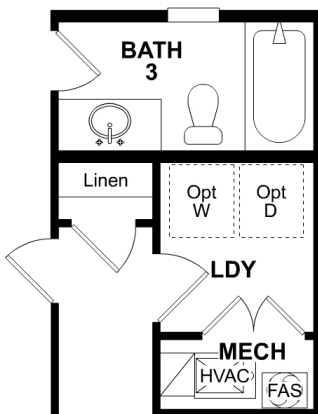

**OPTIONAL BATH 3 ILO STORAGE**

## DETAILS AND FEATURES

- Open-concept kitchen allows you to prepare your meals while still entertaining your guests

- Spacious loft is designed to be a versatile space for play or entertainment
- Convenient upstairs laundry room with abundant storage space
- Walk-in closet located off the primary bathroom for minimal morning disturbance